

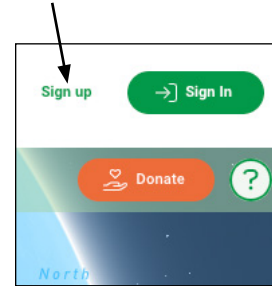

## User Account Setup

[map.homegrownnationalpark.org](http://map.homegrownnationalpark.org)

1. Please [Go to the Biodiversity MAP](#) and click **Sign Up**.



2. Go to your email inbox, open the activation email, and copy the temporary password.

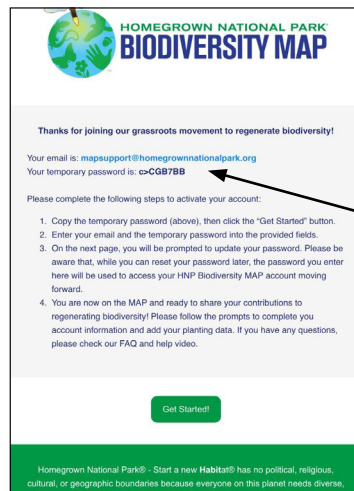

*Make sure you copy only the characters in the password and not any blank spaces.*

3. Click the **Get Started** button in the email to open the **Sign In** page.

4. Enter your email and paste the temporary password. Click **Sign In**.

5. On the next page, you will be prompted to change your password. The password you enter here will replace the temporary one and be used to access your account moving forward.

6. Once you are logged in, you will be presented with the **Complete Registration** window. Enter the requested info and click **Save** to finish your profile.

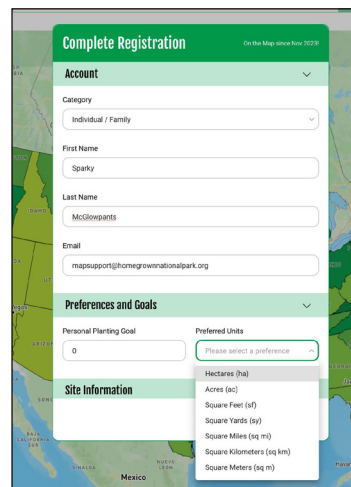

**Complete Registration** On the Map since Nov 2023

**Account**

Category: Individual / Family

First Name: Sparky

Last Name: McGlospaints

Email: mapsupport@homegrownnationalpark.org

**Preferences and Goals**

Personal Planting Goal: 0

Preferred Units: Please select a preference

**Site Information**

Hectares (ha)

Acres (ac)

Square Feet (sq ft)

Square Yards (sq yd)

Square Miles (sq mi)

Square Kilometers (sq km)

Square Meters (sq m)



## Adding a Planting Site & Planted Area

[map.homegrownnationalpark.org](http://map.homegrownnationalpark.org)

- [Sign in](#) to your Map account.
- Enter the address of the new Planting Site in the **Search** field at the top of the Map.
- Select the appropriate option provided by the dropdown list to zoom in on that location.
- Click the green Marker Plus button to the right of the Search field. This will open a new **Site and Planted Areas** window, where you can add your Planting data for the new Site.
  - In the topmost section of this window, **Site Information**, you can refine the placement of your Map marker using the mini-map to the right of the Location field. Just click and drag the red marker on this mini-map to the desired location.
    - Please note that **any info you choose to add to the Name (optional) field in this section will be used to publicly label your Map marker.**
  - You can use the green *Leaf Plus* button to add new Planted Areas at this Planting Site. You can use the Trashcan button to delete the corresponding planted area (**this action cannot be undone once confirmed**).
  - When you're done adding the Planted Areas at your address, click **Save** to record your changes.

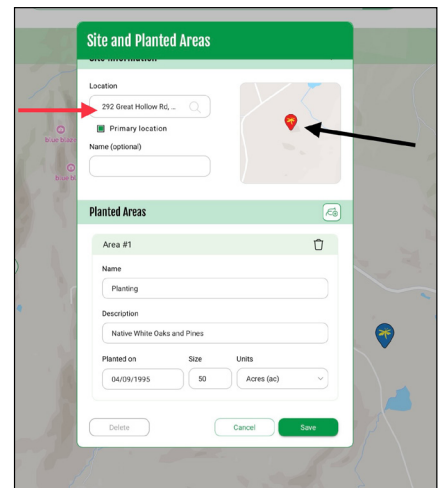

## Adding or editing Planted Area(s) at an existing Planting Site

- Sign in to your Map account, click the green *Map Cog* button in the **Personal** infobox (red arrow in first screenshot). This will open the **My Settings** window, which can also be accessed by clicking your account name in the upper right and selecting **My Settings** from the dropdown menu.

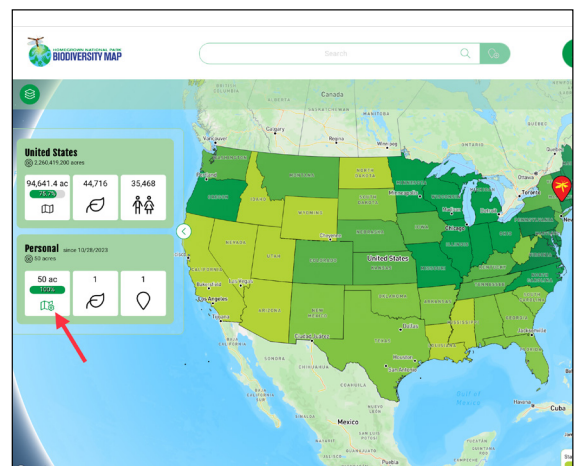



**HOMEGROWN  
NATIONAL PARK  
BIODIVERSITY MAP**

## Adding a New Planting Site & Planted Area(s)

[map.homegrownnationalpark.org](http://map.homegrownnationalpark.org)

- In the **My Settings** window, scroll down to the **Sites** section and click the Go to site button next to your Planting Site. This will open the corresponding **Site & Planted Areas** window.

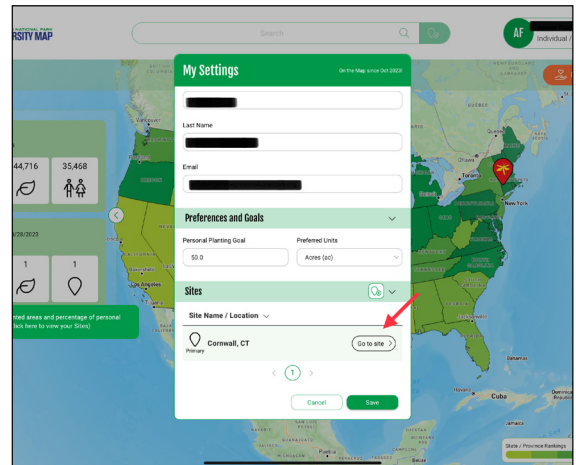

- In the **Site & Planted Areas** window, you can use the green Leaf Plus button (black arrow in screenshot) to add a new planted area at this Planting Site. You can use the *Trashcan* button (red arrow) to delete the corresponding planted area (**please note this action cannot be undone once confirmed**).

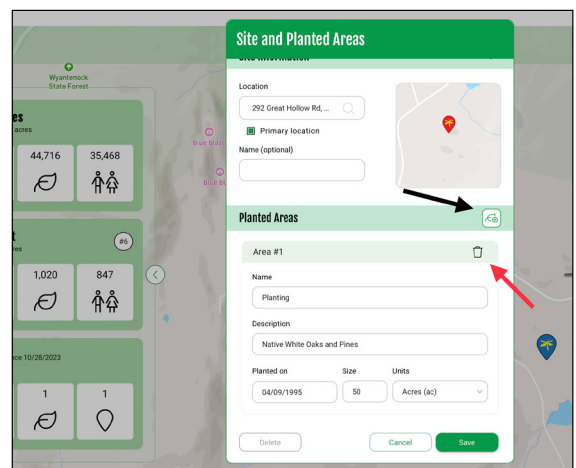

- When you're done adding or editing, remember to click **Save** to record your changes and close the **Site and Planted Areas** window.

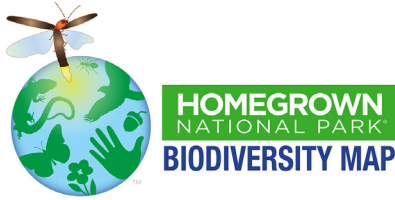

## Biodiversity Map FAQs

[map.homegrownnationalpark.org](http://map.homegrownnationalpark.org)

For visual guidance, you can reference our [video walkthrough](#) for individual Map account creation and management (also available on the Map via the green “?” button in the upper right).

### Basic Map Facts/Terms

Note: Generally, if you’re wondering what an icon or button means, placing your cursor over it will reveal a hover-text description.

When signed in to your Map account:

- All account data is accessible from the **My Settings** window.
- The green *Map Cog* button is a shortcut to access the **My Settings** window. It displays in your *Personal* infobox (lower left) and on any Map marker belonging to your account (when signed in).
- The green *Leaf Plus* button adds a Planted Area. It displays on a Map marker belonging to your account (when signed in) or in a **Site and Planted Areas** window.
- Searching for an address/location and then clicking the green *Marker Plus* button to the right of the Search field creates a new Planting Site at that location; opening a **Site and Planted Areas** window.
- All Planting Sites can be viewed and accessed in the **My Settings** window.
  - Clicking *Go to site* next to a Planting Site will open the corresponding **Site and Planted Areas** window.
  - Clicking the *Marker Plus* button (above and to the right of your list of Planting Sites in the **My Settings** window) will open a new **Site and Planted Areas** window.

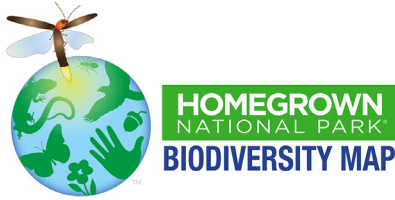

## Biodiversity Map FAQs

[map.homegrownnationalpark.org](http://map.homegrownnationalpark.org)

### What is a Planting Site?

A location with at least one Planted Area. Planting Sites are indicated on the Map by either a Green (Org) or Blue (Individual) Map marker. Depending on the zoom elevation at which you're viewing the Map, markers in the same vicinity cluster together and display as a circle with a number inside. This grouping indicates there are multiple Planting Sites in that area. The number in the middle indicates the quantity of Sites.

As you zoom in, these clusters will often dissipate and be replaced by individual markers. When they do not disperse, that is because the locations associated with those markers cannot be distinguished (e.g. those users have all entered the same city/state/zip info and no differentiating street address). You can still view the markers within a cluster by clicking on a cluster and selecting one of the markers from the list provided.

### What is a Planted Area?

Any area that contains one or more native plants. To gauge the size of any Planted Area, we ask that you please guesstimate using the anticipated footprint of the plant(s) crown(s) at maturity. This applies to herbs, shrubs, trees, etc. Your measurement does not have to be exact, just please do your best to get close using your preferred squared unit of measure (feet, yards, meters, etc).

### Measuring your Planted Area(s)

Since we're interested in the total area occupied by all native plants, there are two possible approaches for recording your Planted Area data. Please choose the approach that works best for the types of native Plantings on a given property.

- You can log each bed/Planting area separately.
- Or you can record the size of each native Planting, sum those figures, and input the total size as one Planted Area.

If you opt for the latter approach (which we recommend for easy data entry), we've created [a simple calculator to streamline the process](#). All we ask is that you exclude any non-native plants from your count. Note that, since habitats are 3-D, you shouldn't worry if the plants you enter into the calculator overlap (e.g. native ground cover, shrubs, and trees in the same area). All those plants are contributing to the habitat, so their respective footprints should all count towards the total size of that Planted Area!